

up-map.it

ver 1.0 (QG26B01IENG)

M Ride



QUICK GUIDE
ENG

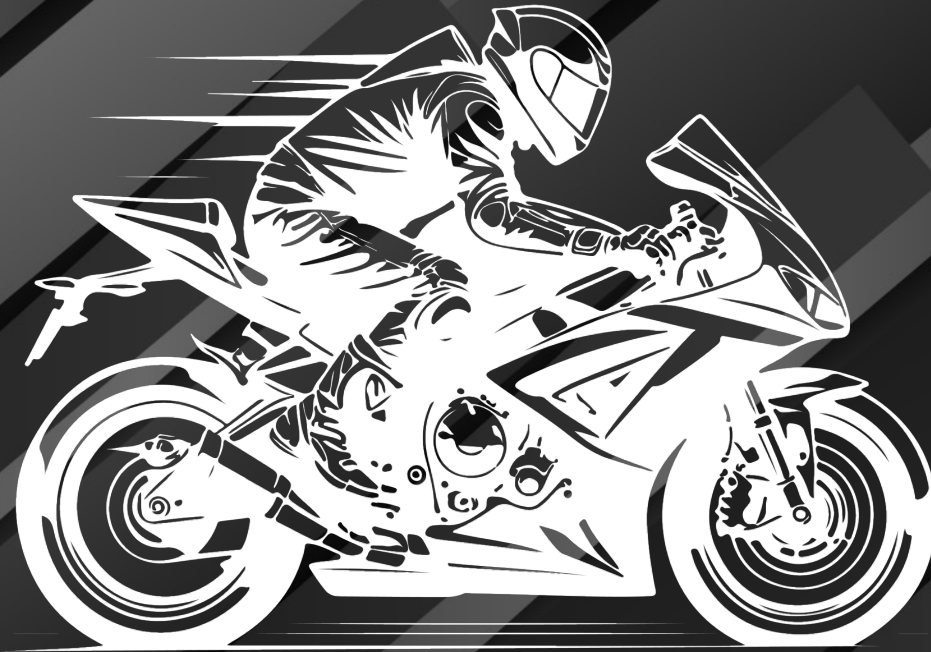

MADE IN ITALY





02 →	DOWNLOAD APP	Download/Install UpMap MRide application on Android/Apple mobile
03 →	LOGIN / REGISTRATION	Create an UpMap user profile. 04- Log in to the application. 06- Authorizations.
07 →	CONFIGURE A DEVICE	Connect the UpMap MRide device and calibrate the throttle grip
15 →	MAP SELECTION	Select and edit the map within the application
21 →	SPECIAL FUNCTIONS	22- Valet Mode. 23- Rev Mode. 24- Real Time. 25- Warm-up.
26 →	PROFILE SETTINGS	Profile settings
29 →	MRIDE TRANSFER	Rename MRide. 30- Free MRide. 32- Transfer MRide. 36- Device State.

Download the App to your mobile



Enter the store and download the UpMap application to your mobile phone.

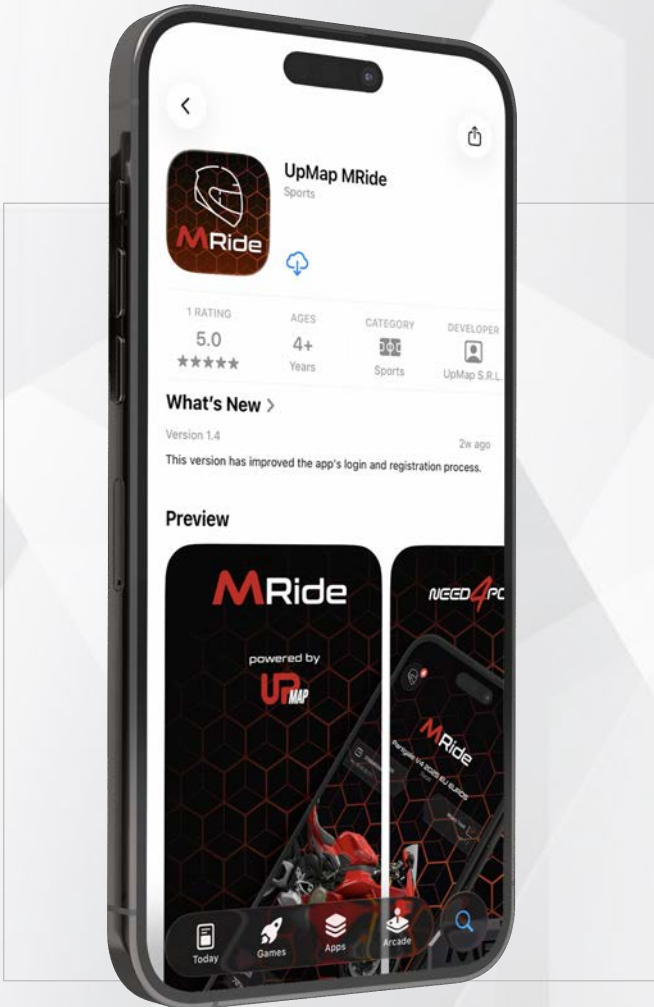

Apple

If you have an **Apple** phone, enter the **App Store**, search for **UpMap** in the search bar and download the UpMap app to your phone.

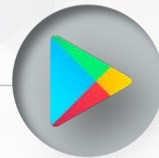

Android

If you have an **Android** phone, enter **Google Play**, search for **UpMap** in the search bar and download the UpMap app to your mobile phone.



Login / Sign Up

Create an UpMap MRide profile and access the application features



Login

If you already have an UpMap account, enter your email and password and log in by pressing **LOGIN**.

Password Recovery

You will be sent a new password to the email address you registered with.

Registration

Enter your details and create an UpMap MRide profile. Press on **SING UP** to proceed.

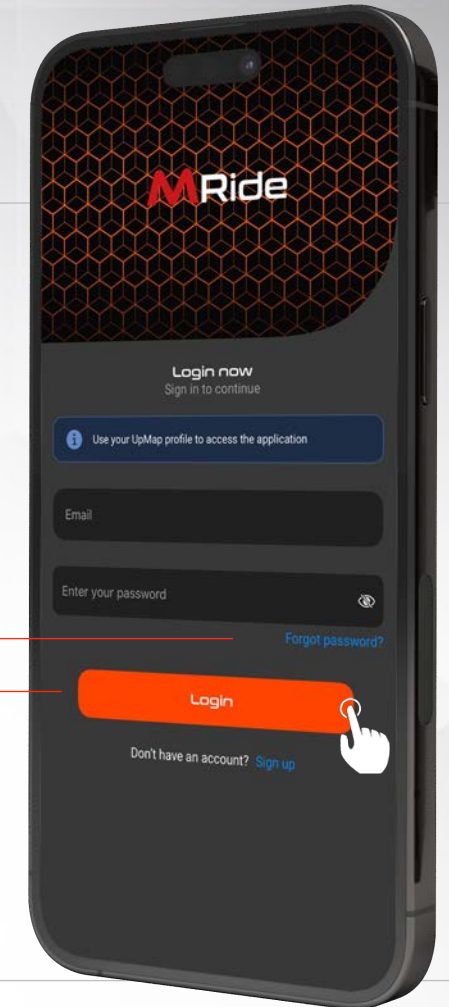
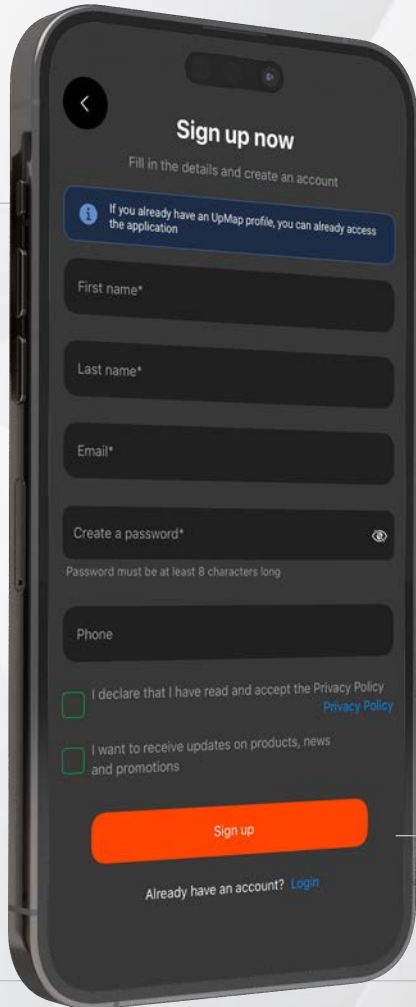

Login / Sign Up

Create an UpMap MRide profile and access the application features



Bluetooth permissions

To connect the device, you need to authorize the connection with Bluetooth by pressing **ALLOW**.

Authentication

Two-factor authentication is required to access the UpMap MRide app.

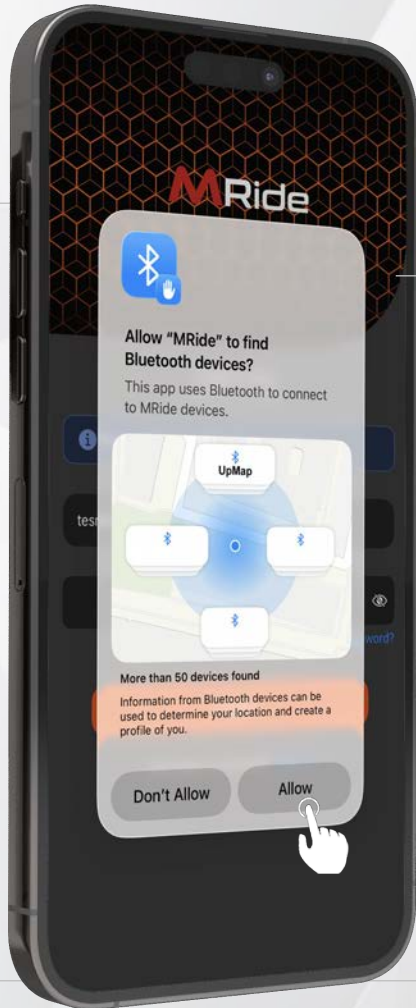

Login / Registration

Create an UpMap MRide profile and access the application features



Verification code

You will be sent a code to the email address you registered with.

Authentication

Enter the code received via email.

Press **VERIFY** to proceed.

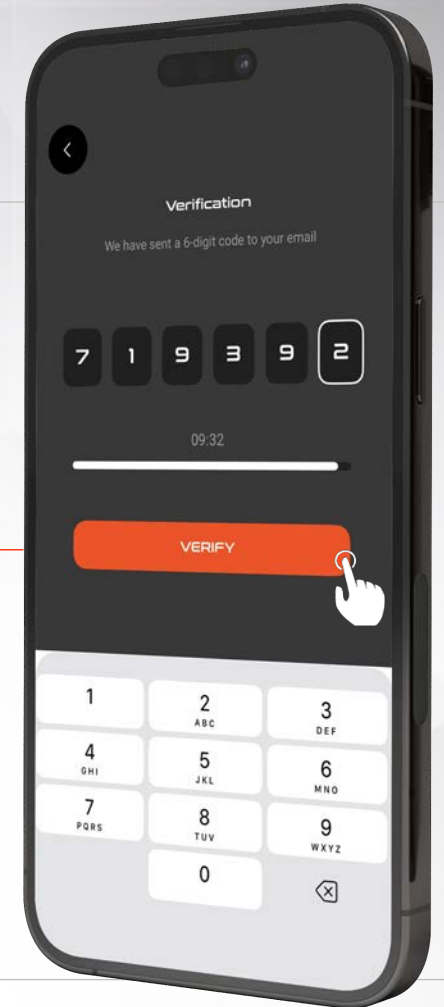
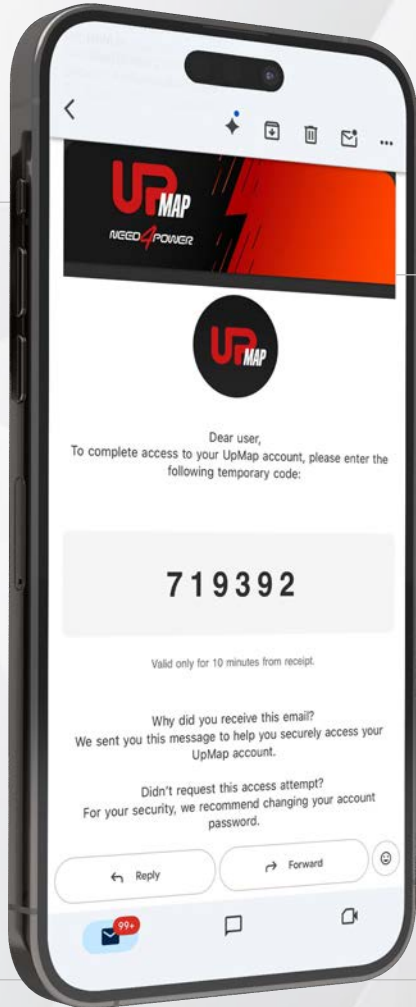

Permissions

Grant the necessary permissions for the UpMap MRide app to function.

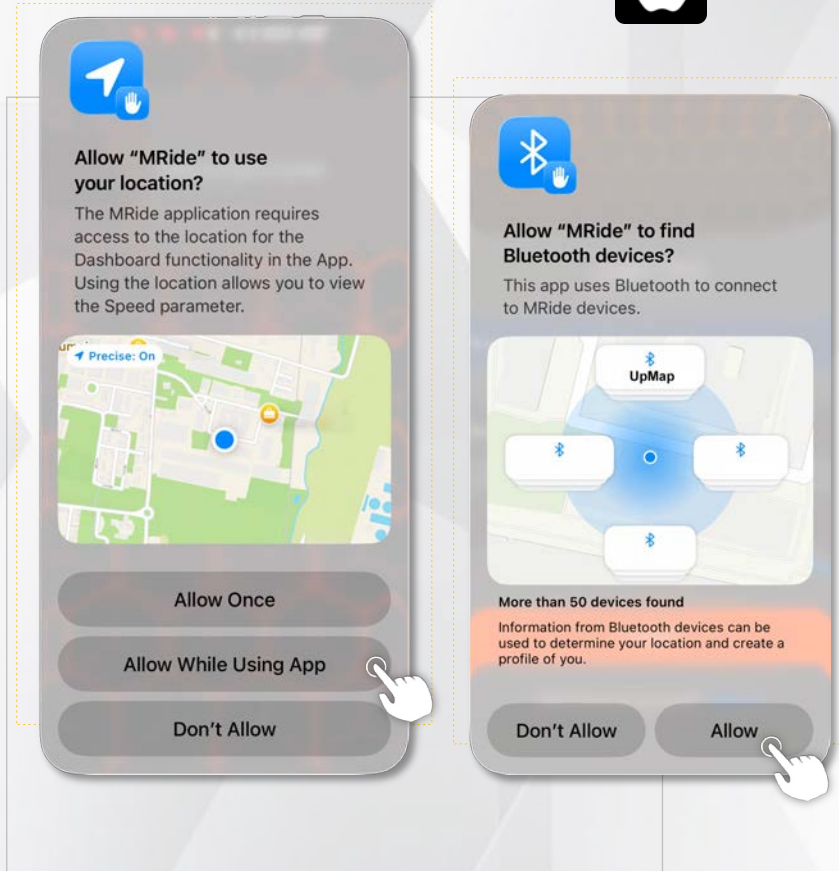

Consent must be given to Bluetooth usage and exact Geolocation.

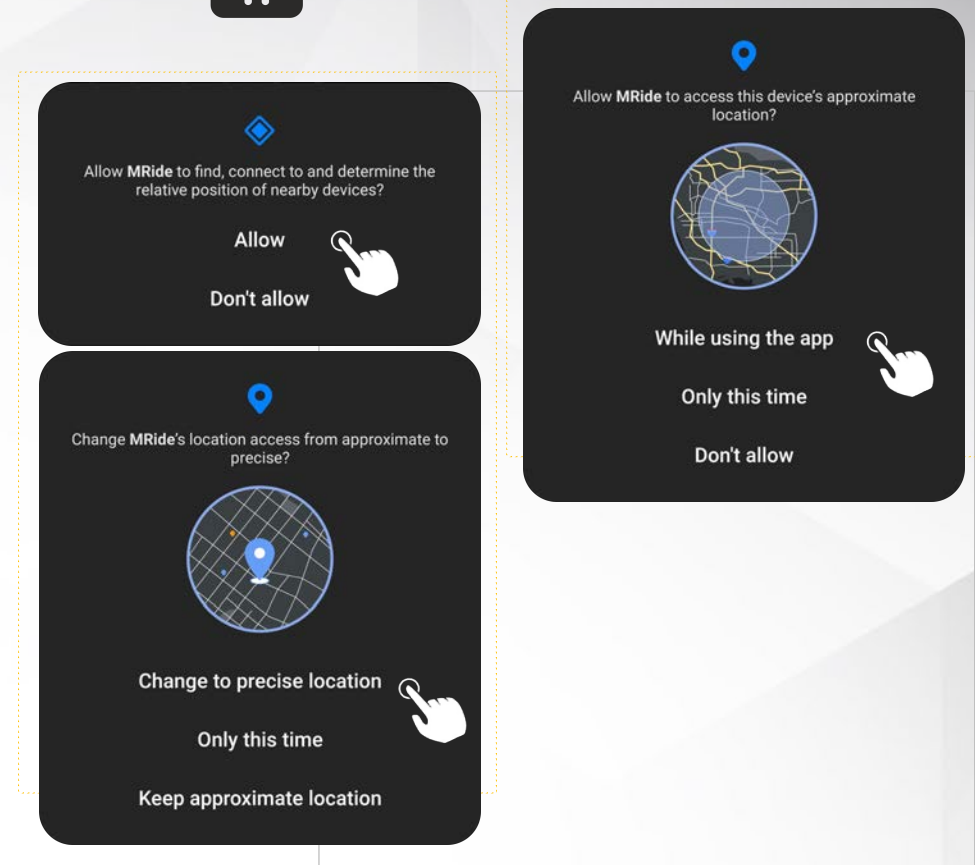

MRide Configuration

Configure an MRide device

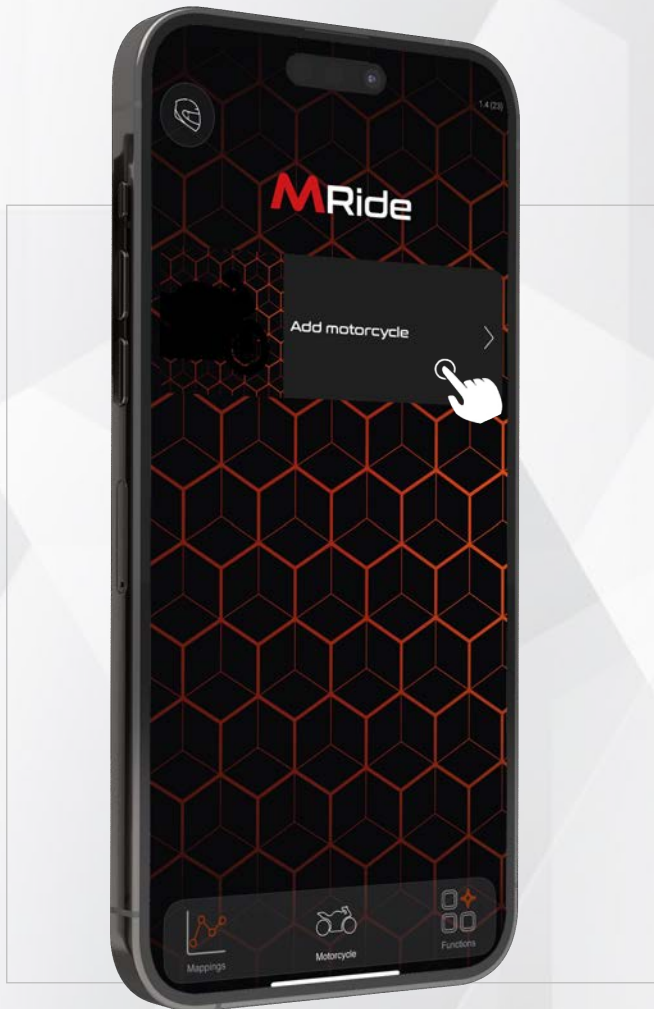

From **HOME** enter **ADD MOTORCYCLE**

Press **PROCEED**



If the dashboard is turned on and the MRide device connected to the vehicle, it will be detected automatically. By clicking ADD you can proceed with the configuration

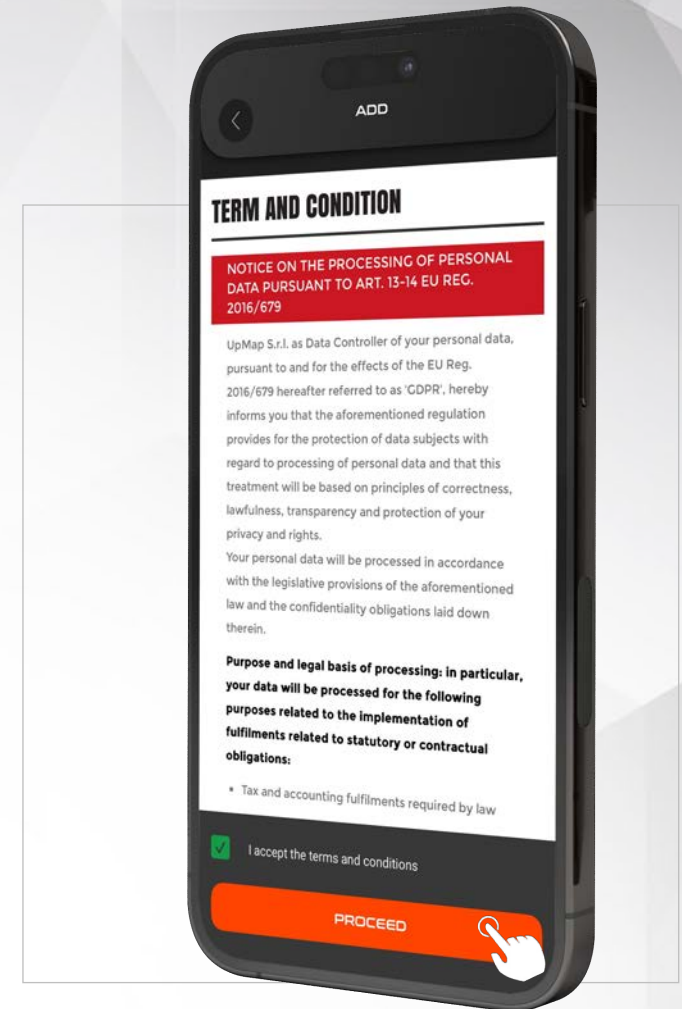

MRide Configuration

Set up an MRide device

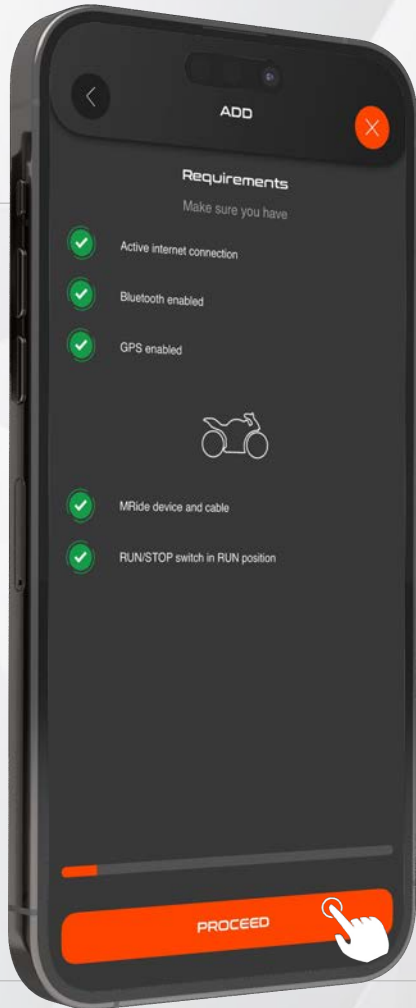

Press on **PROCEED**

Select your **MOTORCYCLE** brand

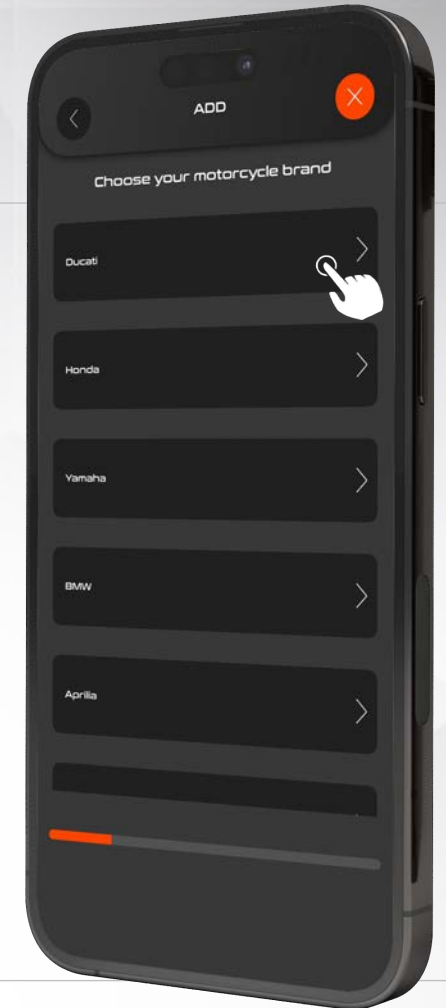

MRide Configuration

Set up an MRide device



Select the **MODEL** of your **MOTORCYCLE**

Press **PROCEED**

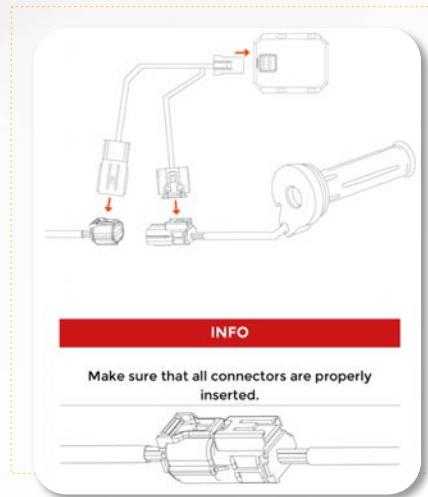

Please refer to the quick start guide for proper device installation.
It is recommended to consult experienced staff for installation.

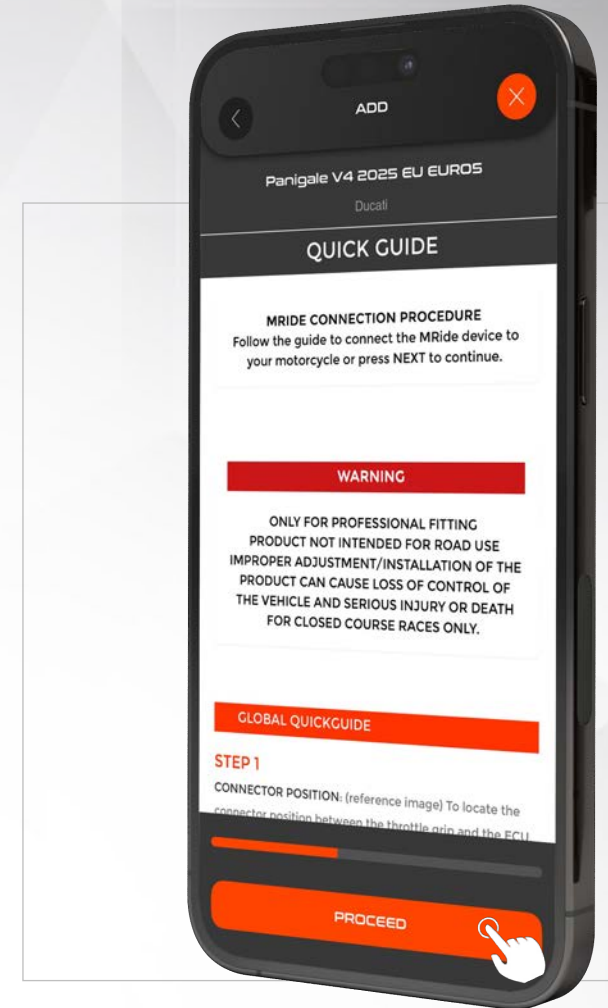
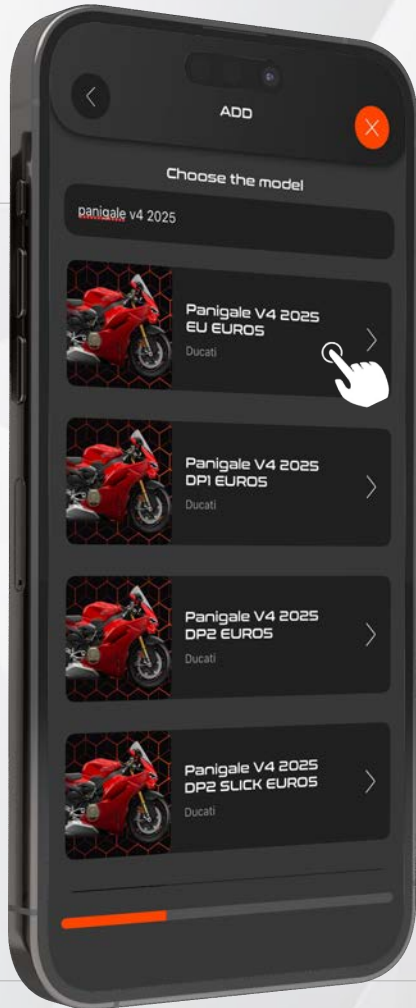

MRide Configuration

Set up an MRide device

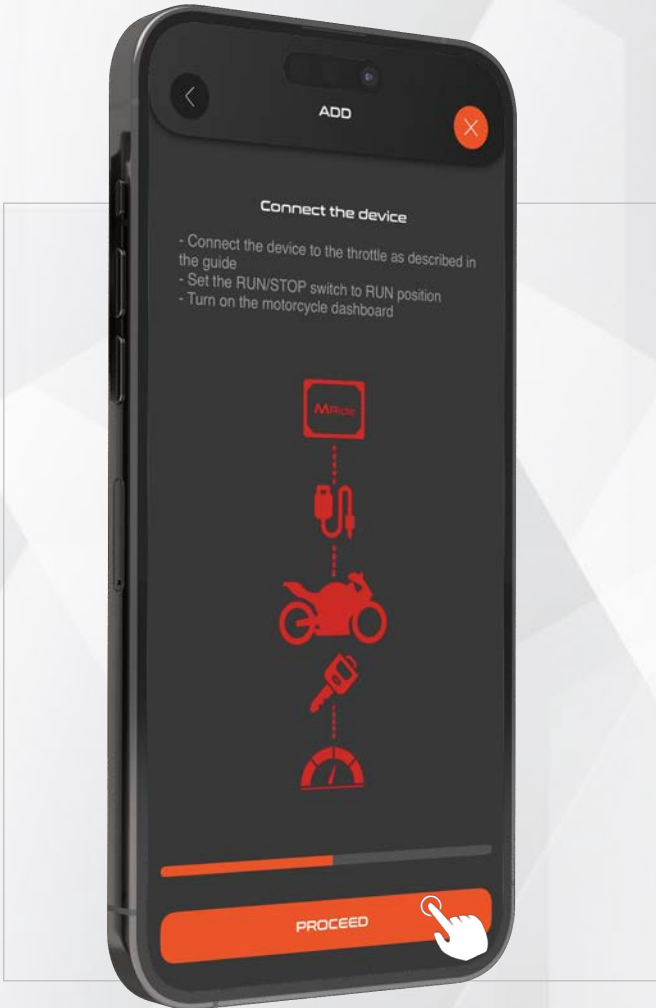

Verify that the device is connected correctly and press on **PROCEED**.

Press on **DEVICE** to proceed.

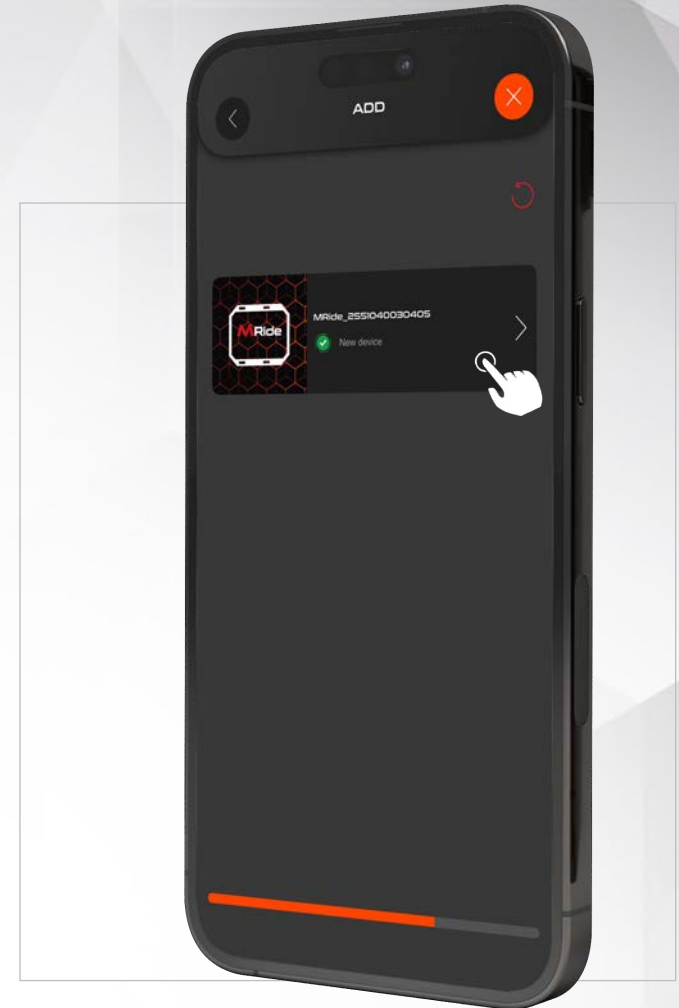

MRide Configuration

Set up an MRide device



Firmware Update

If there is a **FIRMWARE** update for the device, press **UPDATE**.



Do not turn off the dashboard until the update is complete.

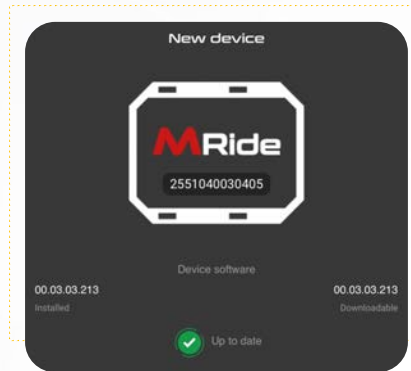

When the Firmware update is complete, you can proceed with the configuration.

Add a device

Connect an UpMap MRide device to the motorcycle

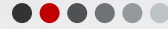

Add Device

Click **ADD** to add Mride.

Configure later

You can later configure the MRide calibration to learn the throttle grip.

Start Calibration

Perform MRide calibration to learn the throttle grip.



In order to use the functionality of the device it is necessary to carry out the calibration.

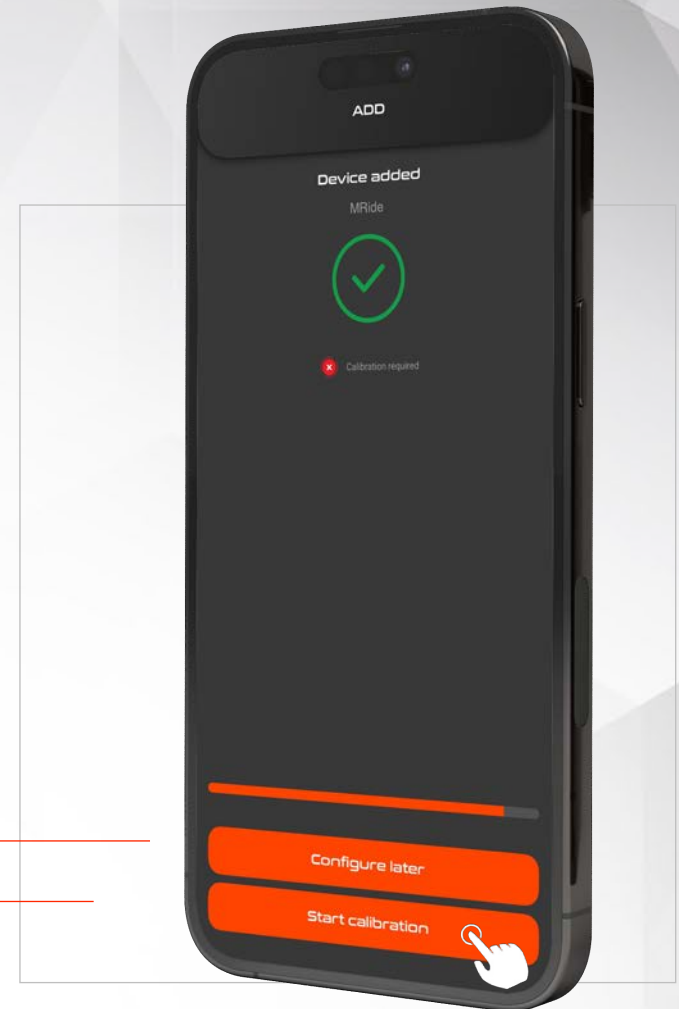

Throttle grip Calibration

Calibration of the throttle grip



Perform calibration

Press on **RUN CALIBRATION** to proceed.

Learn the minimum

Keep the accelerator at **MINIMUM** for at least 3 seconds to learn the minimum value.



Throttle grip Calibration

Connect an UpMap MRide device to the motorcycle



Learn the maximum

Keep the accelerator on **MAXIMUM** for at least 3 seconds to learn the maximum value.

Press on **RUN CALIBRATION**.

End procedure

MRide is correctly calibrated, press **END** to finish the procedure



Map Selection

Install the MRide map on the motorcycle

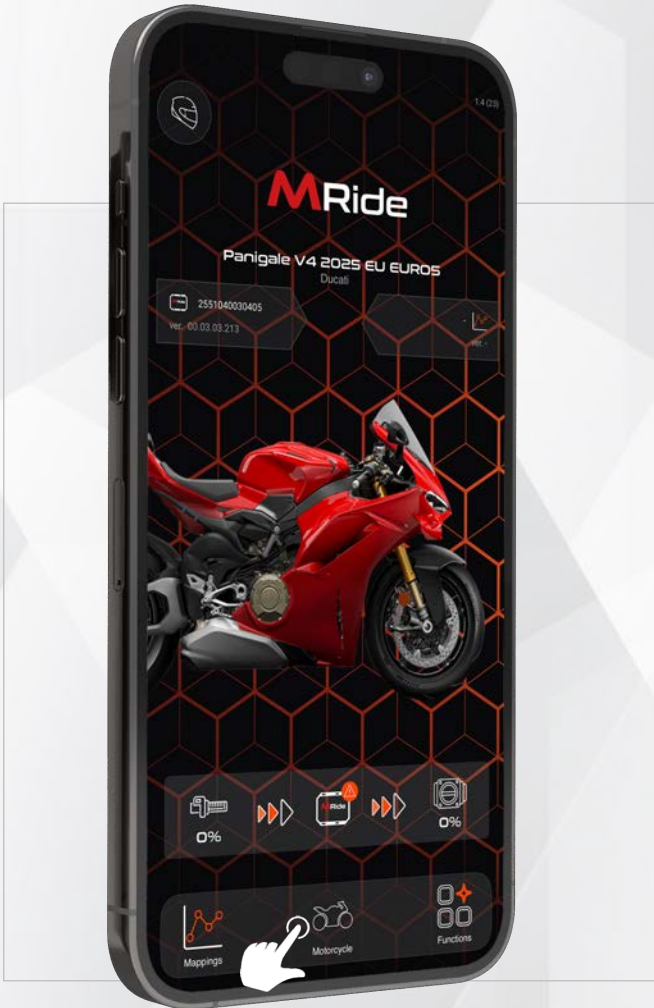
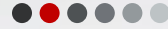

From **HOME** enter **MOTORCYCLE**

Select your **MOTORCYCLE**

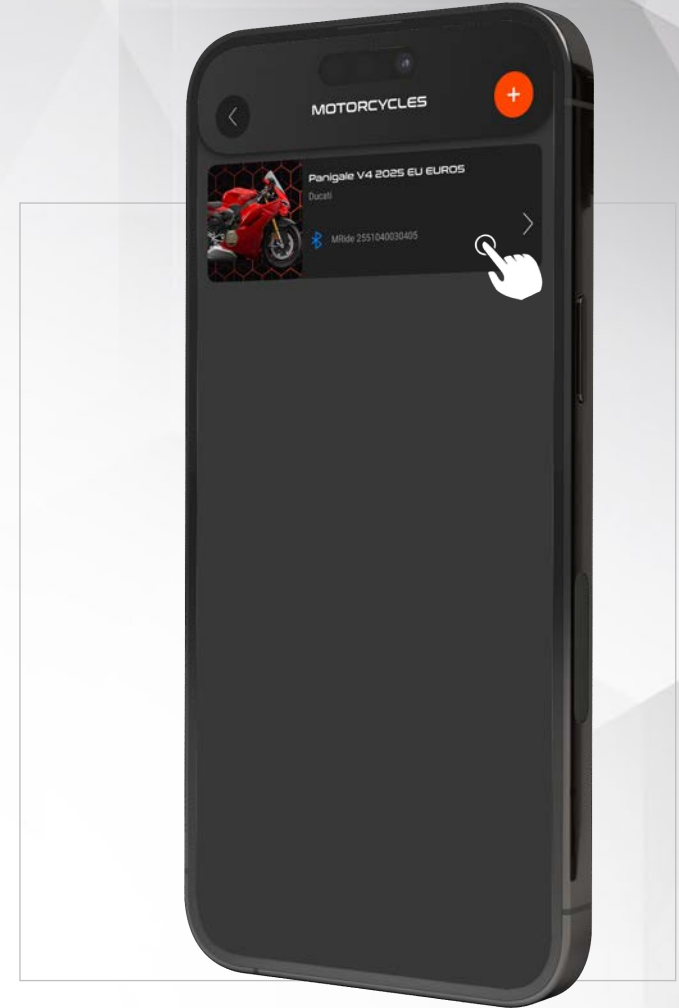

Map Selection

Install the MRide map on the motorcycle

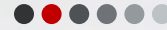

Press on **MAPS**

Select a **MAP**

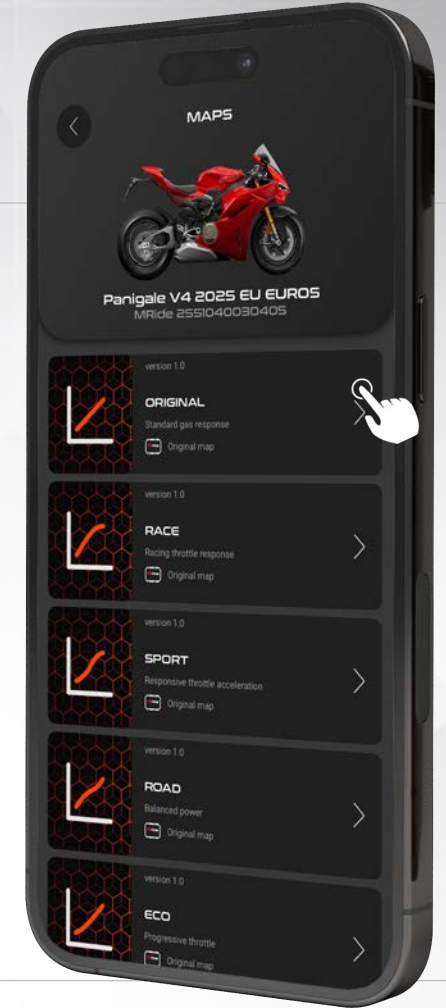

You can proceed with installing one of the default maps, or with creating a custom map.

Map Selection

Create custom MRide map



Clone map

Clone the selected map to make **CHANGES**. Please note: the original maps are not editable.

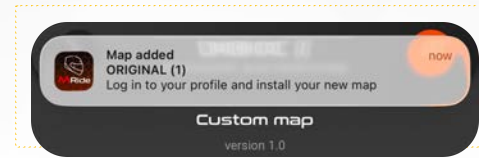
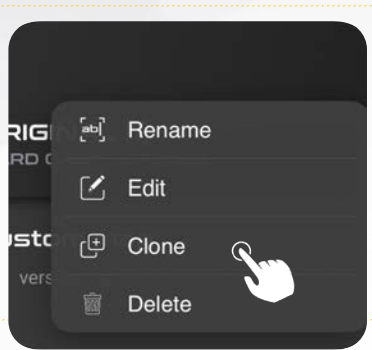

Write map

You can write one of the default map.

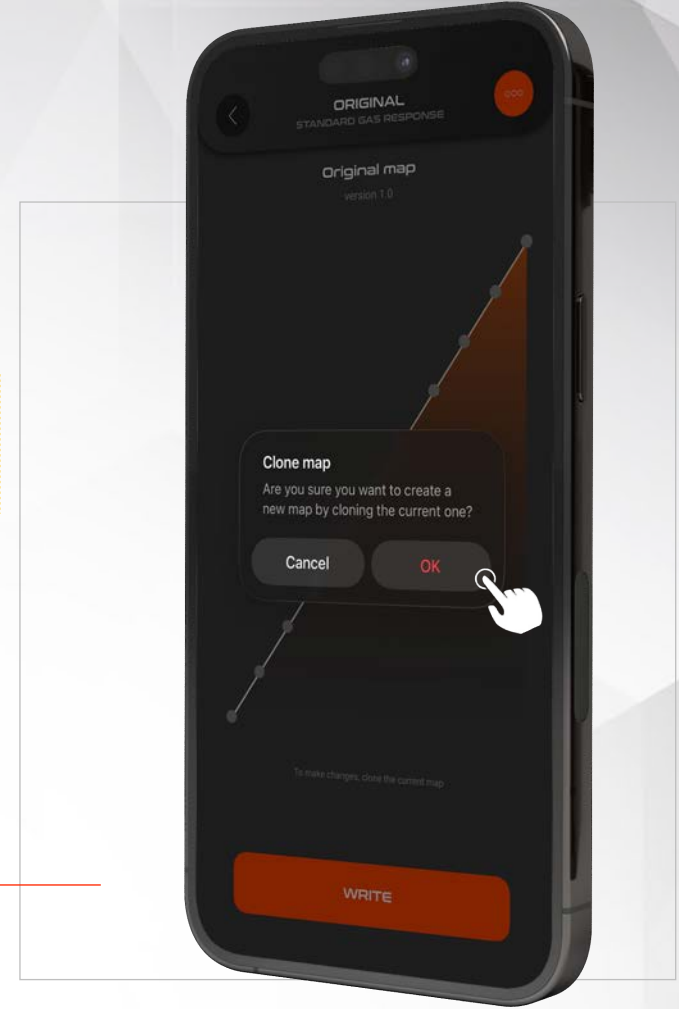

You will receive a notification that the map has been cloned.

Map Selection

Create your custom MRide map

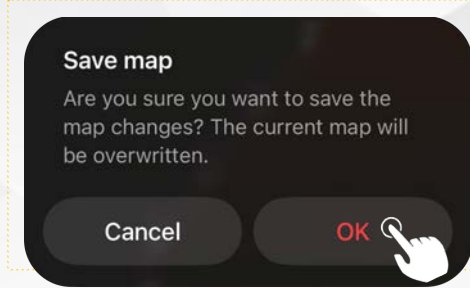
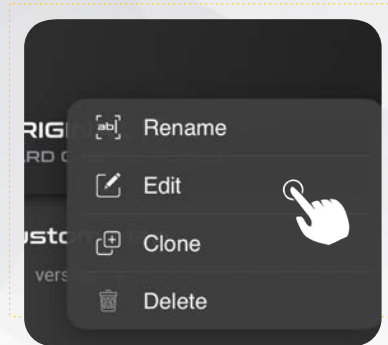

Edit Map

Edit the selected map by dragging the points in the graph, which represent the accelerator opening percentage.

To proceed, press **SAVE**.



Map Selection

Rename custom MRide map

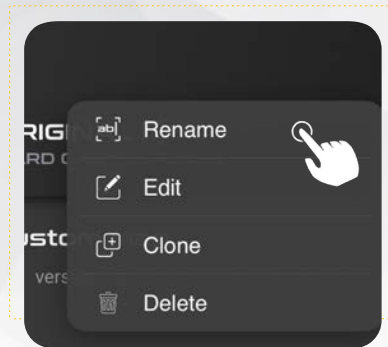

Rename map

You can rename the modified map.

To proceed, press **SAVE**.



Map Selection

Write your custom MRide map

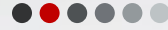

Press **WRITE** to write the **MAP**.

Verify correct **MAP WRITING**.

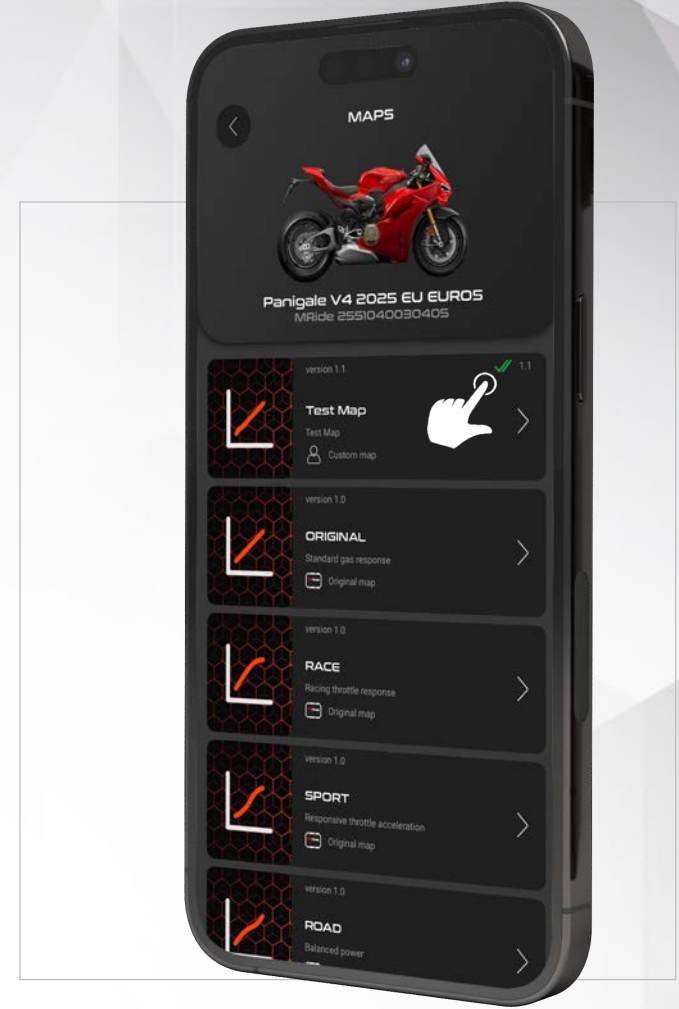
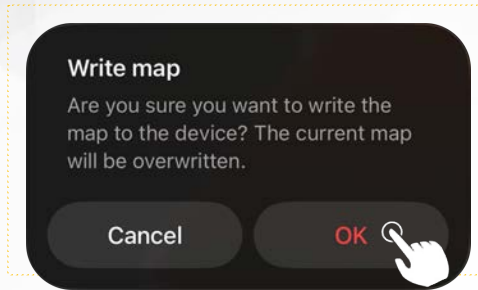

Special Functions

Special functions available on MRide



From **MOTORCYCLE** section enter to the **SPECIAL FUNCTIONS**.

SPECIAL FUNCTIONS available:

- Modalità Valet
- Remote Rev
- Real-time data
- Calibration
- Warm-Up

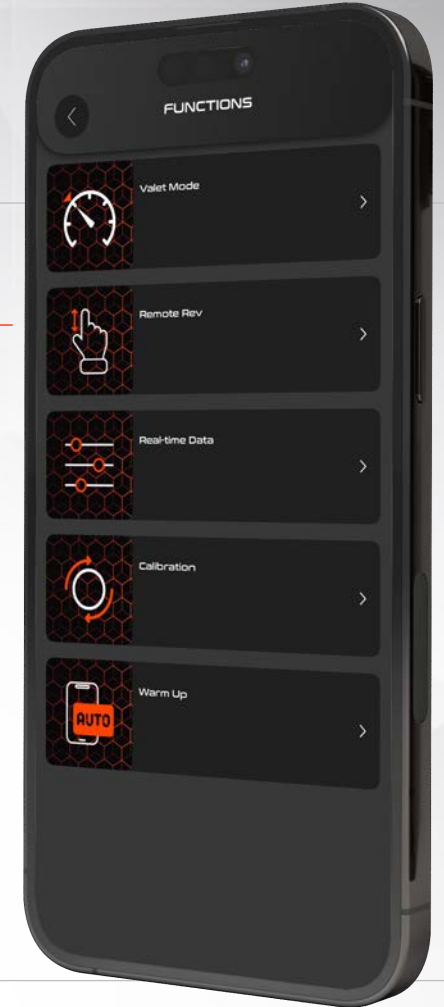
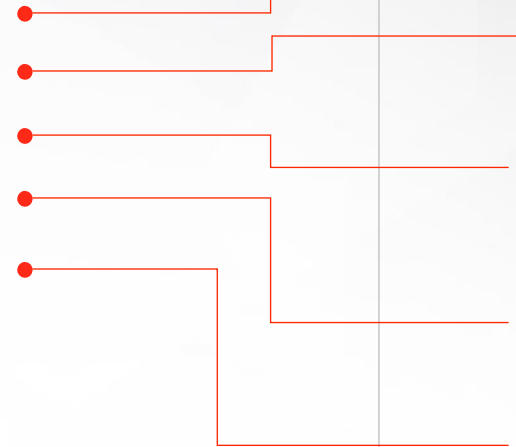

Special Functions

Valet mode

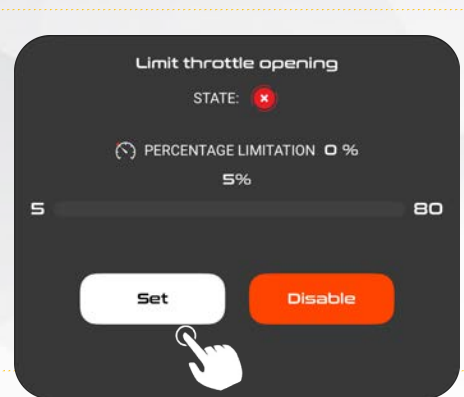
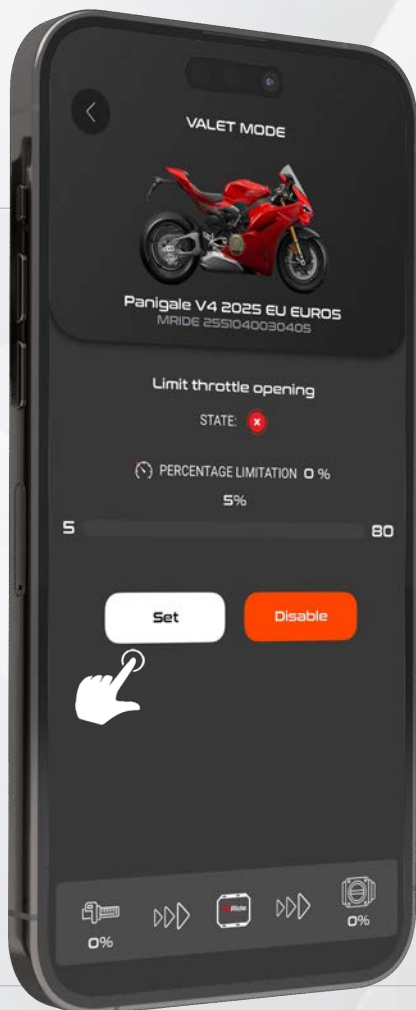

Throttle opening

Decide by what percentage to limit the throttle opening, taking into account your specific needs and the type of use you intend to make of it.

 PAY ATTENTION

Valet mode will always remain active even after the vehicle is turned off, until it is disabled via the app

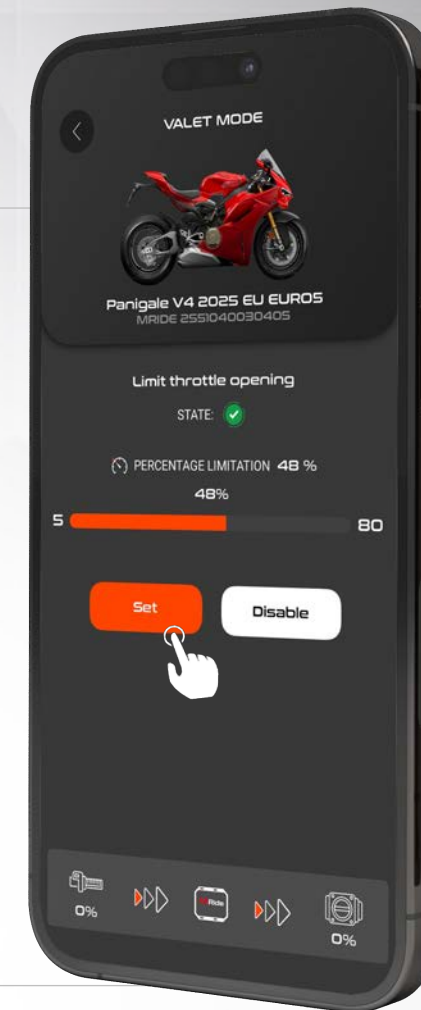

Special Functions

Remote Rev



Remote Rev mode

It allows you to remotely operate the motorcycle's gas control directly from the app.

Swipe on the screen to operate the feature.

PAY ATTENTION

This feature is designed exclusively for short revs at a distance, without any use related to driving or moving the vehicle.



Remote Rev mode is deactivated when the accelerator throttle grip is operated.



Special Functions

Ral Time



Real-time data

View real-time data directly from the app to instantly monitor the effect of MRide changes on accelerator response.

The feedback is immediate and allows you to verify every change clearly and precisely while the system is running.



Special Functions

Warm-Up



The Warm-Up function

It automatically heats the engine to bring it to optimal operating conditions before use. Through the app you can customize its behavior by selecting the maximum opening of the THROTTLE, the duration of each acceleration and the pause between one acceleration and the next, so as to obtain a progressive heating, controlled and adapted to your needs.

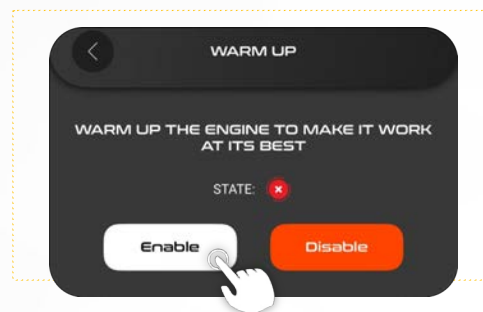

Warm-Up mode is deactivated when the throttle grip is operated.

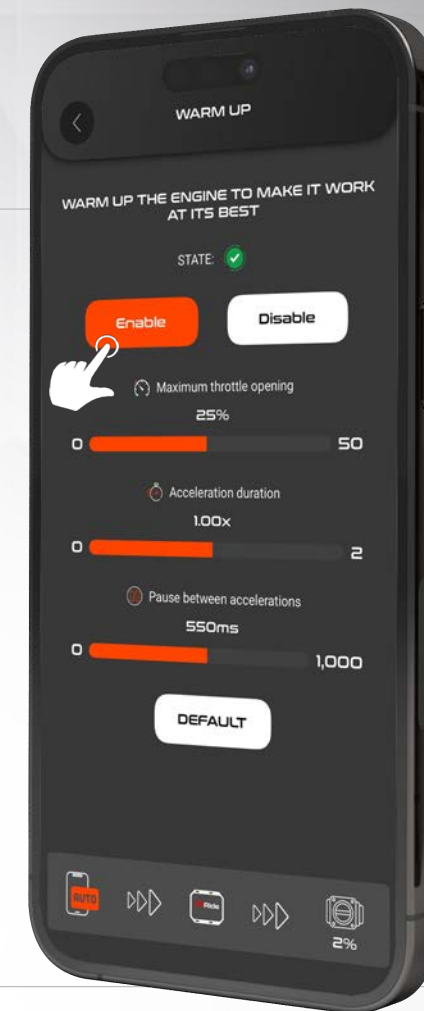

Profile Settings



MRide Profile Settings



From **HOME** enter the **PROFILE**.

Press on the **PROFILE**

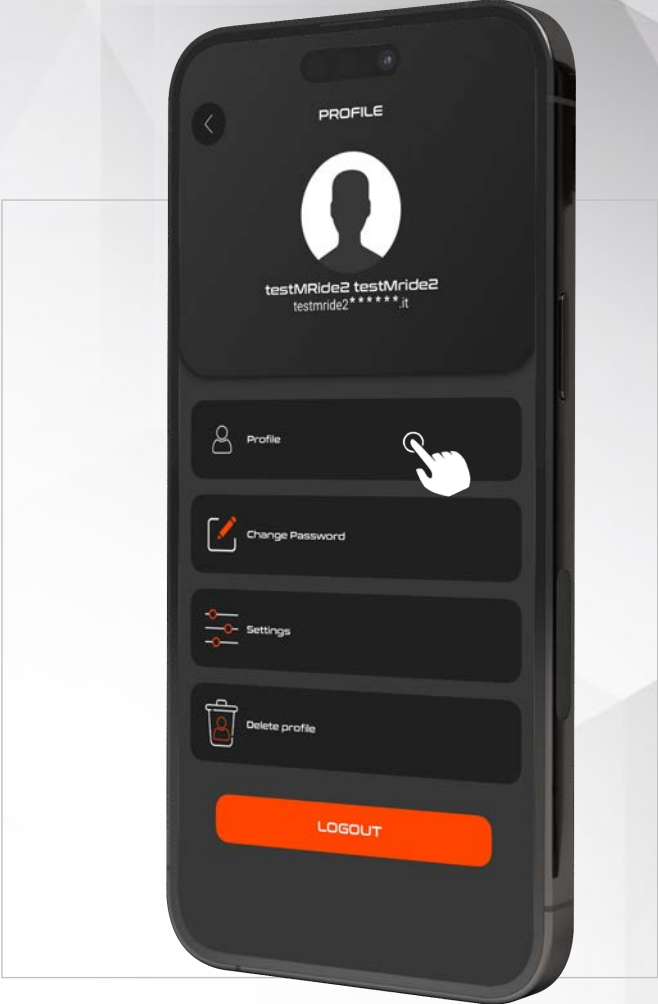

Profile Settings

MRide Profile Settings



User Code

It is available in both alphanumeric and QR Code formats, to make device transfer management more immediate.

The following code can be used to transfer a device. The QR Code can be shown to the application of the user who wants to transfer the device to you.

51*****5



Change password

It is possible to change the password within the profile.

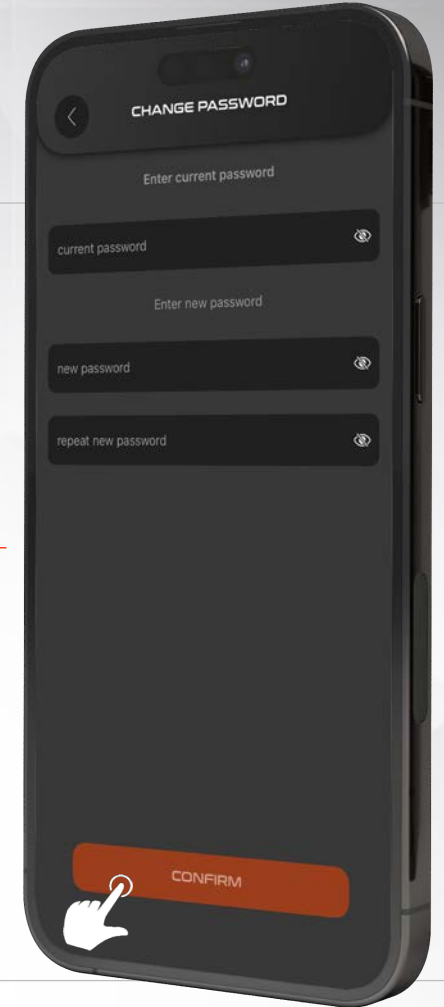
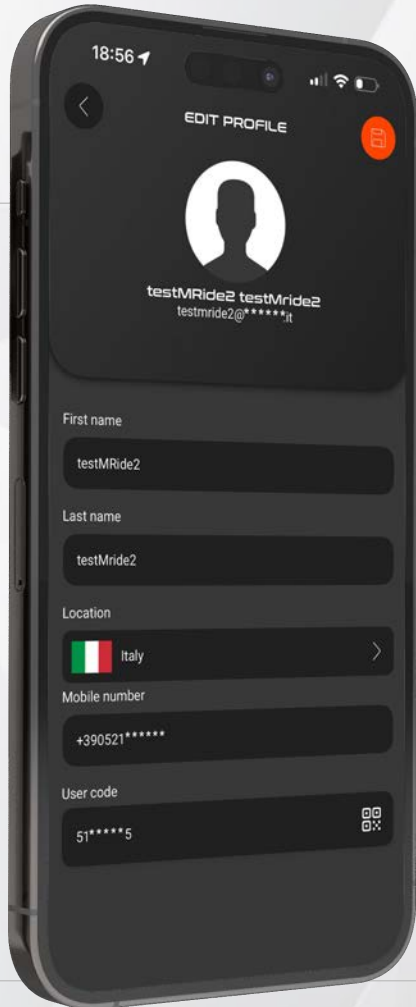

Profile Settings

MRide Profile Settings



Language Settings

It is possible to change the language of the application.

Delete Profile

It is possible to delete the MRide profile.

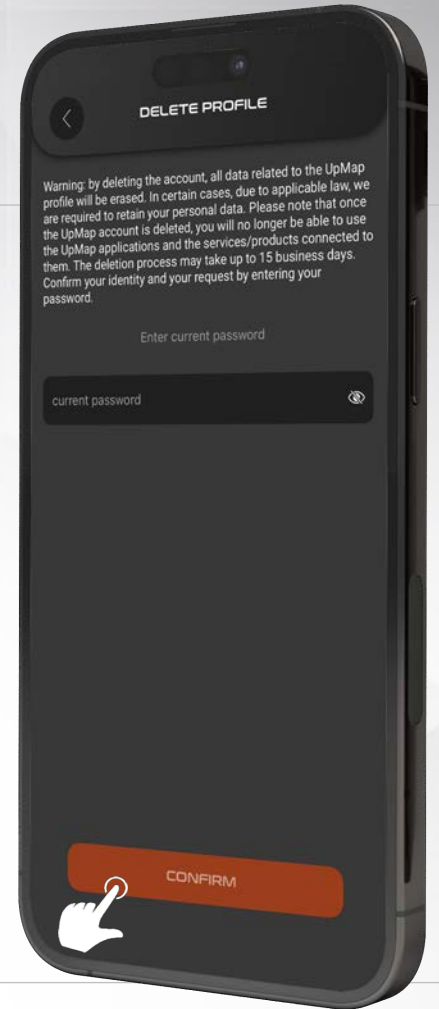
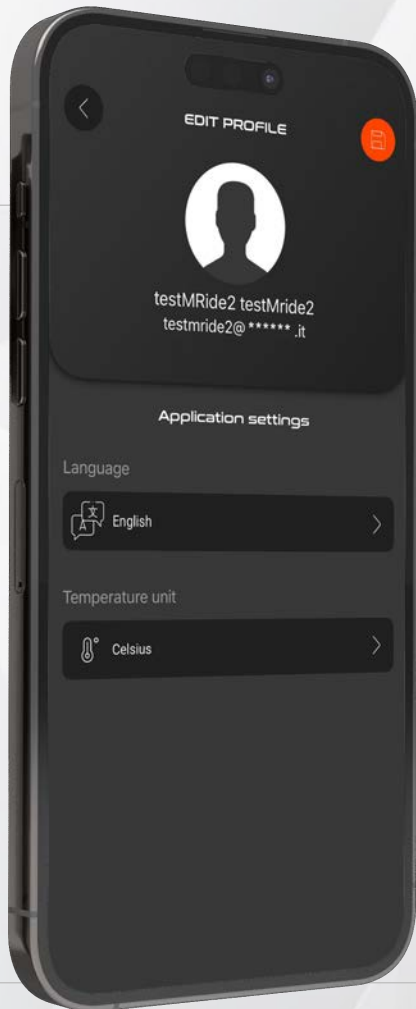

Rename MRide

Connect an UpMap device to the motorcycle

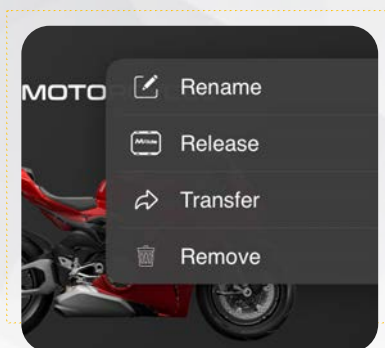

Rename MRide

It is possible to rename the device.

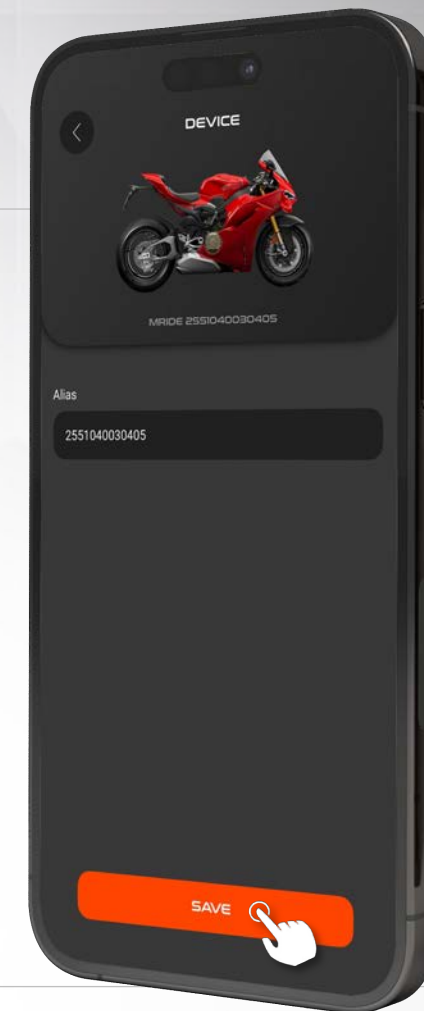

Release MRide

Release the device



Press on **MOTORCYCLE**

Select **DEVICE**



REQUIREMENTS

- MRide device connected to the motorcycle
- Dashboard of the motorcycle on
- MRide connected to the application  Connesso



Release MRide

Release the device

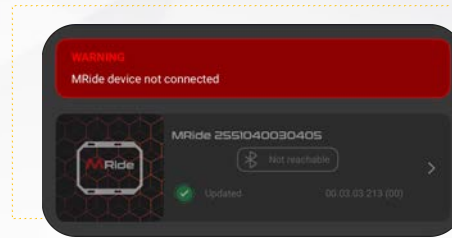
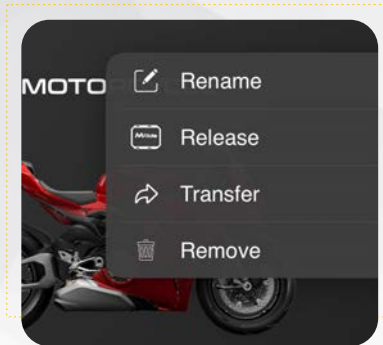

Release MRide

The "Release MRide" feature allows to factory reset your device, eliminating any previous configuration and enabling transparent mode. Once this is done, the device is ready to be safely installed and configured on another motorcycle.

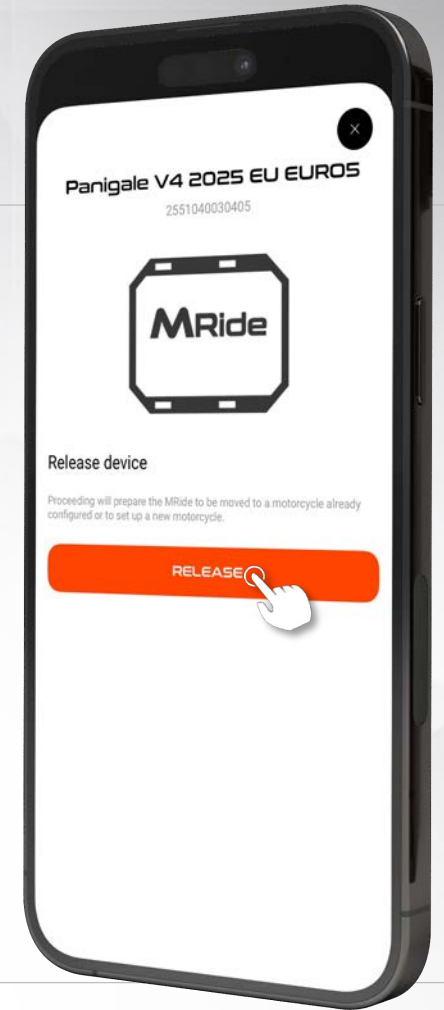

MRide Transfer



MRide Transfer



Transfer MRide

Manage the transfer of the device to a new user, by entering the user code or framing the QR Code.

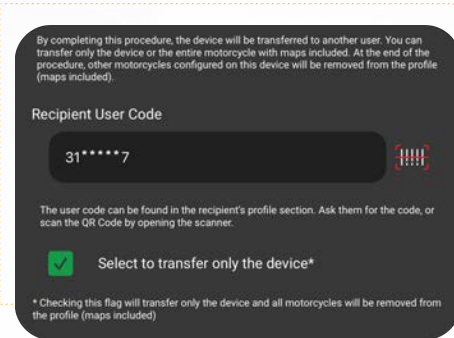
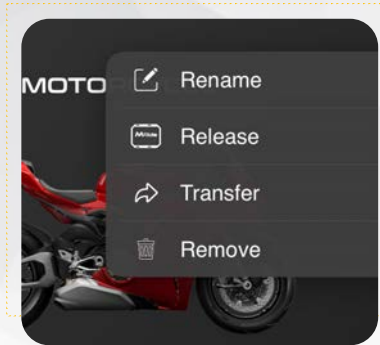

Device + Motorcycle: Configurations and maps remain associated and pass to the new owner.

Device Only: The device is factory reset and ready for a new installation

MRide Transfer

MRide Transfer



Press **TRANSFER** to confirm.

The **TRANSFER** is in progress

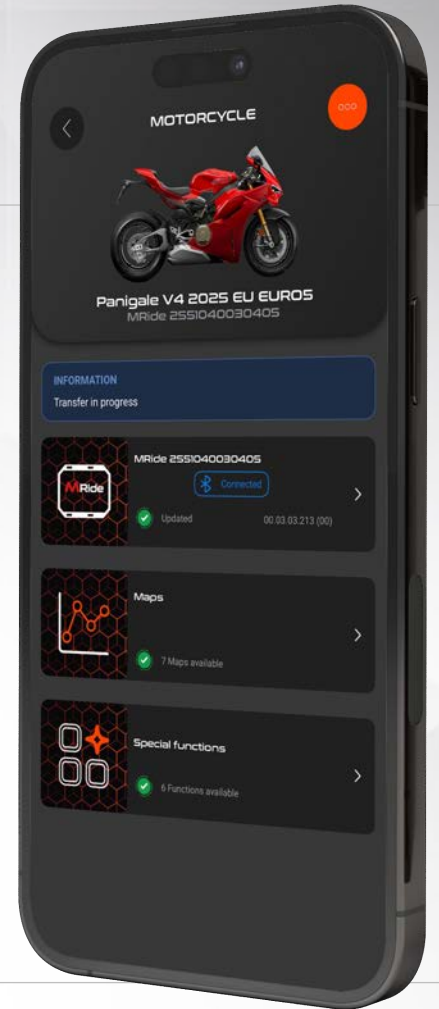

MRide Transfer

Outgoing MRide Transfer

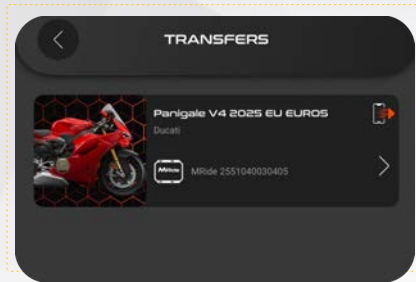
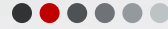

Transfer in progress

Manage the outgoing device transfer, with the option to revoke it.



The transfer of the device alone is irreversible.

MRide Transfer

Accept MRide transfer

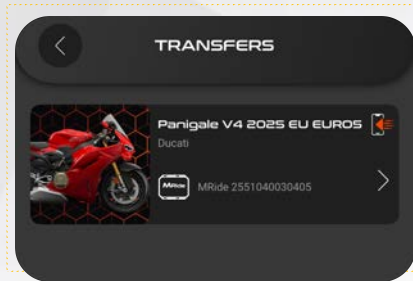
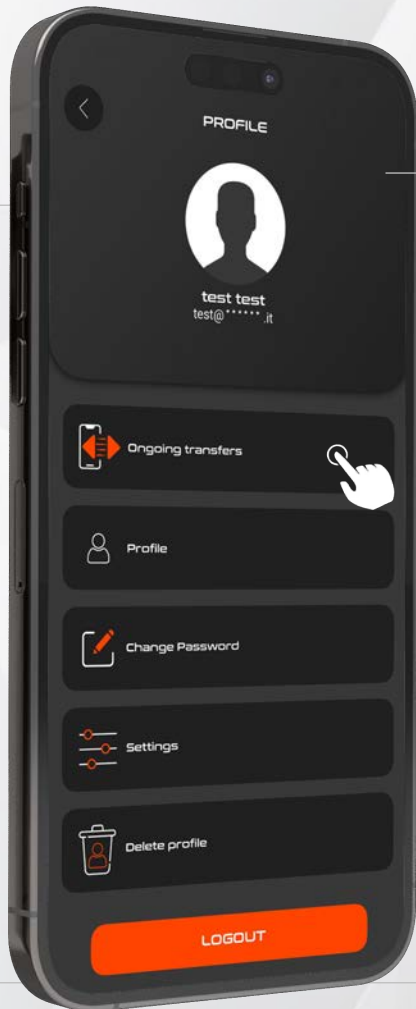

Transfer in progress

Manage incoming device transfer.

It is possible to accept or refuse the transfer.



Device + Motorcycle: Configurations and maps available in the profile.

Device Only: The device is ready for a new installation.

Device Status

led



Fast Flashing – Transparent Mode

- Configuration not present
Carry out calibration
- Map not present
Write map

Fast Fade – Connected

- Configuration present
- Map present
- Connected to the application
Ready-to-use device

Slow Fade – Not Connected

- Configuration present
- Map present
- Not connected to the application
Ready-to-use device

Fixed LED – Error

- Device in error, contact technical support



up-map.it



MRide

MADE IN ITALY



UpMap S.r.l.



Via Alfredo Veroni 11A,
43122 Parma (PR) Italy



+39 0521 646083

info@up-map.it

www.up-map.it